

\$1,700,000 - Ee20 S Mcgee Drive, Alys Beach

MLS® #909695

\$1,700,000

Bedroom, Bathroom, 5,227 sqft

Land on 0.12 Acres

ALYS
BEACH
BLOCK EE

ALYS BEACH, Alys Beach, FL

Homesite North of 30A within close proximity to the upcoming Alys Beach newest amenity - The Silva. This homesite is adjacent to a natural wetland park.

Essential Information

MLS® #	909695
Price	\$1,700,000
Sold Price	\$1,700,000
Date Sold	2023-02-15
Days until Sold	131
Square Footage	5,227
Acres	0.12
Type	Land
Sub-Type	Vacant Land
Status	Sold

Community Information

Address	Ee20 S Mcgee Drive
Area	18 - 30A East
Subdivision	ALYS BEACH
City	Alys Beach
County	Walton
State	FL
Zip Code	32461

Amenities

Amenities	Beach, Deed Access, Elevators, Exercise Room, Playground, Pool, Sauna/Steam Room, Tennis, TV Cable, Waterfront, Whirlpool
-----------	---

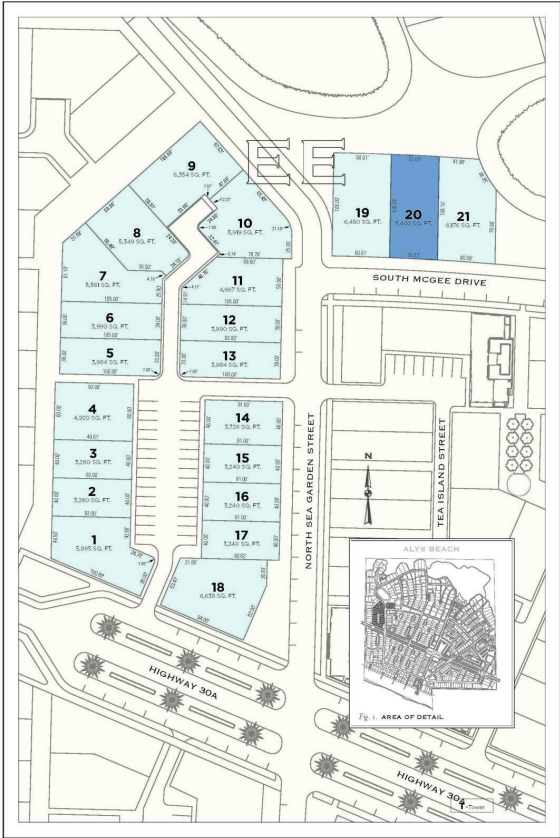

* Refer to the Alys Beach Design Code for all applicable setbacks. ALYS BEACH is a trademark of EBS&CO Industries, Inc. © 2022

Utilities	Electric, Gas - Natural, Public Sewer, Public Water, TV Cable, Underground
-----------	--

School Information

Elementary	Dune Lakes
Middle	Emerald Coast
High	South Walton

Additional Information

Days on Website	589
Zoning	Resid Single Family
HOA Fees	1822.50
HOA Fees Freq.	Quarterly

Listing Details

Listing Office	Alys Beach Properties Llc
----------------	---------------------------