

\$1,475,000 - Gg8 Whitten Way, Alys Beach

MLS® #904219

\$1,475,000

Bedroom, Bathroom, 7,405 sqft

Land on 0.17 Acres

ALYS BEACH, Alys Beach, FL

The Phase 4, GG Block section of Alys Beach will be a neighborhood where nature dominates the scene and weaves its way through a varied collection of picturesque homes organized around an expansive wetland park and nature preserve. The collection of cottage homes and gardens embraces the adjacent nature preserve and wetland park. The neighborhood streetscape is characterized by a reflective canvas of undulating white garden walls that open into landscaped courtyards and gardens -- all set against a variegated assortment of the green and gold textures of the rugged natural setting. A neighborhood that is a bit more 'country' than 'town.'

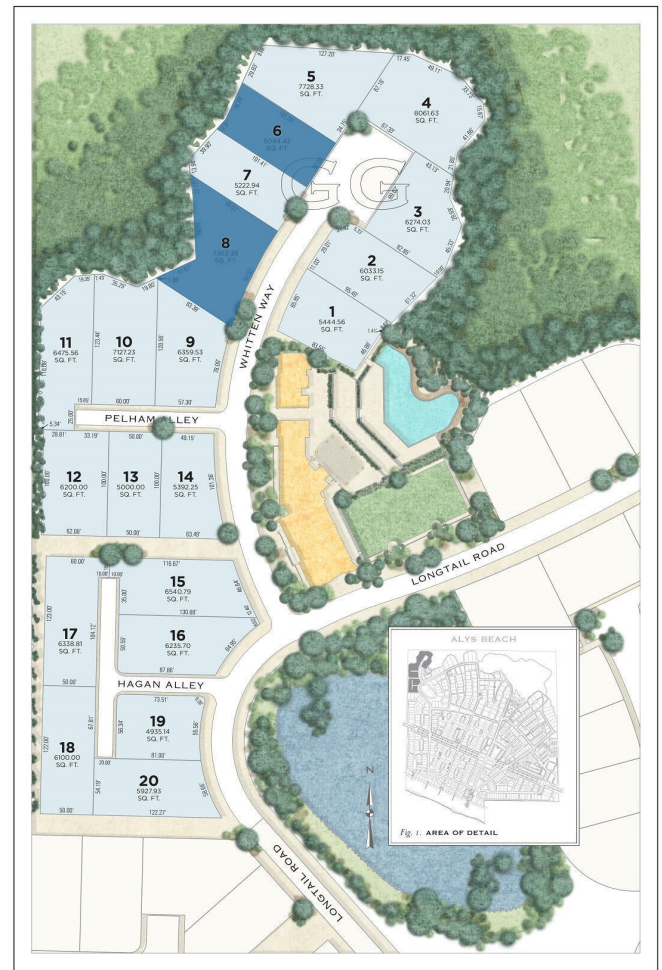

Essential Information

MLS® #	904219
Price	\$1,475,000
Sold Price	\$1,651,101
Date Sold	2022-08-23
Days until Sold	33
Square Footage	7,405
Acres	0.17
Type	Land
Sub-Type	Vacant Land
Status	Sold

Community Information

Address	Gg8 Whitten Way
Area	18 - 30A East
Subdivision	ALYS BEACH
City	Alys Beach
County	Walton
State	FL
Zip Code	32461

Amenities

Amenities	Beach, Deed Access, Elevators, Exercise Room, Playground, Pool, Sauna/Steam Room, Tennis, TV Cable, Waterfront, Whirlpool
Utilities	Electric, Gas - Natural, Public Sewer, Public Water, TV Cable, Underground
Features	Irregular

Exterior

Lot Description	Irregular
-----------------	-----------

School Information

Elementary	Dune Lakes
Middle	Emerald Coast
High	South Walton

Additional Information

Days on Website	664
Zoning	Resid Single Family
HOA Fees	1822.50
HOA Fees Freq.	Quarterly

Listing Details

Listing Office	Alys Beach Properties Llc
----------------	---------------------------